

GATE VALVE WITH LEVER HANDLE

Art.0030 / Item 0030

Thread: BSP parallel UNI EN ISO 228/1



Brass gate valve with lever handle



Brass gate valve with steel handle

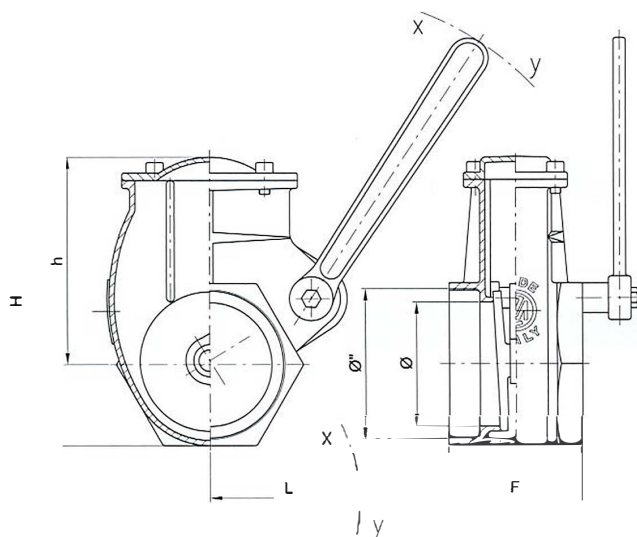

Ø"	2"	2"1/2	3"	4"	6"
Ø	48	63	75	93	145
H	117	147	170	218	320
h	81	104	121	157	232
L	228	237	268	323	465
F	80	86	90	100	102
gr ~	1.950	2.450	3.800	6.300	10.650

Part Numbers

Brass gate valve with lever handle 3"	65 - 5076LH
Brass gate valve with lever handle 4"	65 - 5102LH
Brass gate valve with lever handle 6"	65 - 5152LH

Spare Steel lever handle 3"	65 - 5076H
Spare Steel lever handle 4"	65 - 5102H
Spare Steel lever handle 6"	65 - 5152H

* Also available 2 and 2 1/2" gate valves and spare handles

Parts Listing

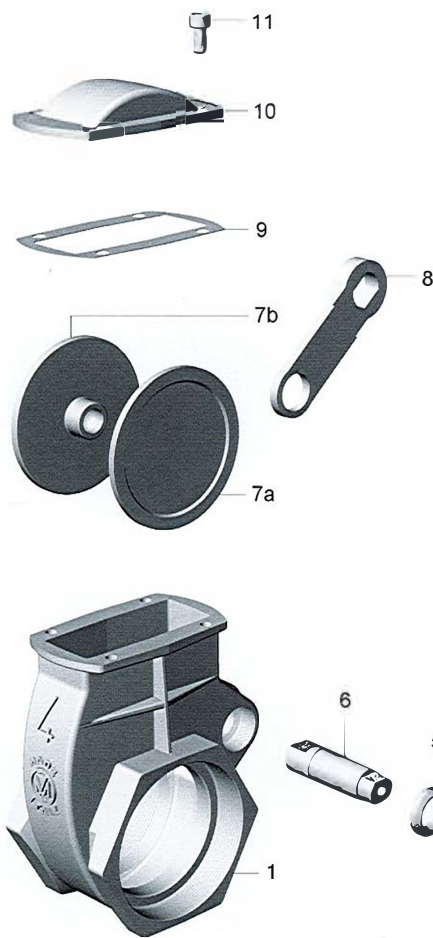

Work conditions

DN	2" ÷ 6"
P (bar)	6
P (PSI)	90
T (°C)	-15 +80

Ø" (in) - DN (mm) conversion table

Ø"	2"	2"1/2	3"	4"	6"
DN	050	070	080	100	150