

TECHNISCHE ÄNDERUNGEN VORBEHALTEN · NACHDRUCK UND KOPIEN NUR MIT UNSEREM EINVERSTÄNDNIS · Specifications subject to change without notice · Copyright ELAFLEX

GRUPPE 1 Section	GE- WICHT	SCHLAUCH- GRÖSSE			Betriebsdruck Work. Pressure bar	Prüfdruck Test Pressure bar	Unterdruck max. Vacuum bar	Biegeradius Bend. Radius mm	Rollenlänge Coil Length ≈ m	BESTELL- NUMMER
	Weight Approx. ≈kg/m	IDin.	IDmm	ODmm						Part Number Type



0,3	3/8"	10	20	25	40	0,8	70	40	LPG 10 *)
0,4	1/2"	13	23			0,5	80	40	LPG 13
0,6	3/4"	19	31			0,5	100	40 (50) (60) (80)	LPG 19
0,8	1"	25	38			0,4	150		LPG 25
1,0	1 1/4"	32	45			0,3	175		LPG 32
1,2	1 1/2"	38	52			0,2	200	LPG 38	
2,0	2"	50	66			0,2	250	LPG 50	
3,4	3"	75	93			-	450	40	LPG 75
4,3	4"	100	118			-	750	40	LPG 100
7,9	6"	150	173			-	1200	30	LPG 150 **)
12,7	8"	200	232	30	-	2000	30	LPG 200 **)	

Type

LPG

'Orange Band' **Liquid Petroleum Gas** hose to EN 1762. For propane, butane and their mixtures to EN 589. As the hose lining is resistant to diff usion the hose is also suitable for natural gas. Not suitable for ammonia.

Rugged and long-lasting construction with low tensile braids. Permitted working pressure 25 bar, burst pressure > 100 bar. Temperature range - 40° C up to + 70° C (Special type LPG-LT does not crack down to - 50° C). Approved by DVGW, approval No. DG-4621 AU 0049.



LPG 32 · EN 1762 · D · FLÜSSIGGAS · L.P.GAS · TEMPERATUR - 40° C + 70° C · Ω · DVGW – DG-4621 AU 0049 · M · PN25 BAR / WP350PSI · ELAFLEX GERMANY · 3Q-15

Application: As reel hose for supplies to domestic and industrial storage tanks, as pump hose for vehicle refuelling, for bulk loading and unloading from rail tankers, road tankers and ships. For special suction / pressure operation needs the type **LPGS** with stainless steel helix is available on request.

*) **Please Note:** marking of LPG 10 (BUTAPAL 10) with longitudinal orange stripe.

Marking: orange bands every 2,5 mtr.. Continuous, abrasion resistant embossing as specified in the EN standard 1762, as per example above.

- Lining** : Nitrile rubber (NBR), black, electrically conductive, diffusion resistant
- Reinforcements** : Textile braids with 2 crossed tinned copper strands
- Cover** : Chloroprene (CR), black, electr. conductive, flame and abrasion resistant, ozone, UV and ageing resistant

nach DGRL Kat. III – siehe Seite 197
**) acc. PED Cat III – see page 198

Assembly and tests: For L.P. Gas hoses only suitable safety fittings acc. to EN 14422 or EN 14424 must be used which can be mounted tightly, see examples below. According to EN 1762, hose assembling must include a mandatory pressure and conductivity test.

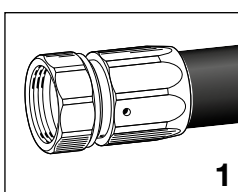

Type M

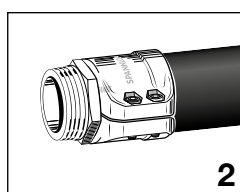

Type SVC - NPT

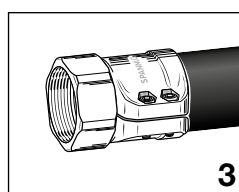

Type SMC

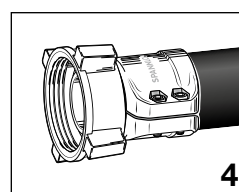

Type ACM (ACME)

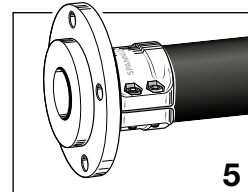

Type SFC

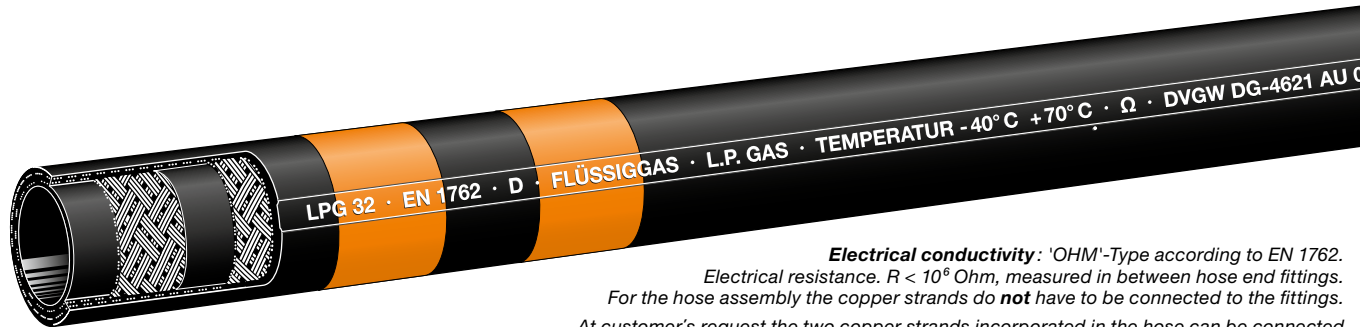

Electrical conductivity: 'OHM'-Type according to EN 1762. Electrical resistance. R < 10⁶ Ohm, measured in between hose end fittings. For the hose assembly the copper strands do **not** have to be connected to the fittings. At customer's request the two copper strands incorporated in the hose can be connected to the hose fittings with resulting electrical resistance R < 10² Ohm ('M'-type according to EN 1762).

LPG 16 Autogas Hose

Weight Approx. ≈ kg/m	Hose Size			Work. Pressure bar	Test Pressure bar	Vacuum bar	Bend. Radius mm	Coil Length ≈ m	Part Number Type
	ID in.	ID mm	OD mm						
0,5	5/8"	16	26	25	40	0,5	80	40 max. 80	LPG 16

Hose for L.P. Gas dispensers. Meets the EN 1762 standard. For propane, butane and other L.P. gases.
Highly flexible and long-lasting construction. Burst pressure

> 100 bar. Temperature range - 40°C up to + 70°C.
DVGW approval No. DG-4621 AU 0049.

Type

LPG 16

Type LPG 16 ist ein hoch flexibler Standard-Zapfschlauch für die Autogas-Betankung. Der weichmacherfreie Innengummi schließt Auswaschungen aus. Basierend auf dem Slimline Zapfschlauch (siehe S. 111), verfügt LPG 16 über eine schwarze, glatte Oberfläche, geprickt und fortlaufende, Prägemarkierung in dauerhaft abriebfester Qualität:

LPG 16 – EN 1762 · AS 1868 · Ω · PN 25 · M · ELAFLEX © GERMANY · 3Q-15

Type LPG 16 is a highly flexible standard Autogas hose for L.P. Gas dispensers. The plasticiser-free lining guarantees that no components can be washed out. Based on the Slimline petrol pump hose (see page 111), LPG 16 has a black, smooth surface, perforated and a continuous, abrasion resistant embossed marking as per example above.

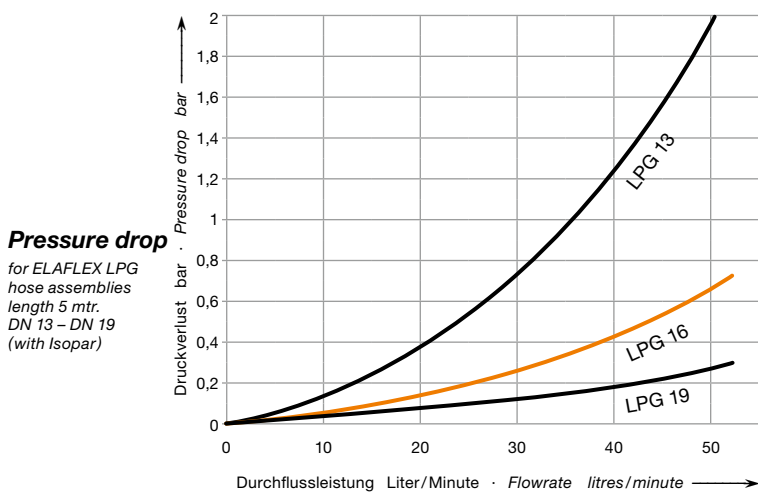

- Lining** : NBR, black, seamlessly extruded, electrically conductive, low diffusion, plasticiser-free
- Reinforcements** : low tensile textile braids with crossed tin-plated copper strands electrically connectable
- Cover** : CR, black, smooth, perforated, electrically conductive, highly abrasion resistant, highly ageing resistant

The complete kit for LPG dispensers

